

THREADED / THREADLESS GALVANIZED STEEL CONDUIT ACCESSORIES (CONDULETS-1)

PRODUCT TYPE	CONDULET TYPE "C"
PRODUCT CODE	MLC-201
MANUFACTURER	PRO-STAR
MATERIAL	MADE OF CAST ALUMINUM
COATING	RAL 7042 ELECTROSTATIC PAINTED

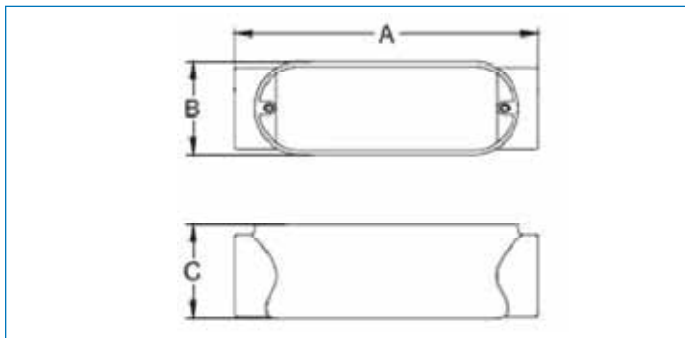

CERTIFICATES			

MSM Code	Manufacturer's Code	Thread Size	A (mm)	B (mm)	C (mm)	Quantity per Package (pcs)	Package Weight (kg)
MLC-201	C-050	1/2"	119,06	33,34	34,93	10	1,2
MLC-202	C-075	3/4"	139,70	39,69	41,28	10	1,6
MLC-203	C-100	1"	163,51	46,04	47,63	6	1,3
MLC-204	C-125	1 1/4"	212,73	63,50	63,50	2	0,9
MLC-205	C-150	1 1/2"	212,73	63,50	63,50	2	1,0
MLC-206	C-200	2"	268,29	80,96	85,73	2	1,2
MLC-207	C-250	2 1/2"	-	-	-	1	2,0
MLC-208	C-300	3"	-	-	-	1	3,0
MLC-209	C-400	4"	-	-	-	1	4,0

Usage Areas
Used for cable pulling and conduit direction change in EMT/IMC/RSC type conduits.
Has a steel sheet cover, sealed.